

Product Information

COPYRIGHT ©2019 Hangzhou Hikvision Digital Technology Co., Ltd. ALL RIGHTS RESERVED.

Any and all information, including, among others, wordings, pictures, graphs are the properties of Hangzhou Hikvision Digital Technology Co., Ltd. or its subsidiaries (hereinafter referred to as "Hikvision"). This user manual (hereinafter referred to as "the Manual") cannot be reproduced, changed, translated, or distributed, partially or wholly, by any means, without the prior written permission of Hikvision. Unless otherwise stipulated, Hikvision does not make any warranties, guarantees or representations, express or implied, regarding to the Manual.

About this Manual

This Manual is applicable to Wireless Tag Reader.

The Manual includes instructions for using and managing the product.

Pictures, charts, images and all other information hereinafter are for description and explanation only. The information contained in the Manual is subject to change, without notice, due to firmware updates or other reasons. Please find the latest version in the company website (<http://overseas.hikvision.com/en/>).

Please use this user manual under the guidance of professionals.

HIKVISION Trademarks Acknowledgement and other Hikvision's trademarks and logos are the properties of Hikvision in various jurisdictions. Other trademarks and logos mentioned below are the properties of their respective owners.

Legal Disclaimer

TO THE MAXIMUM EXTENT PERMITTED BY APPLICABLE LAW, THE PRODUCT DESCRIBED, WITH ITS HARDWARE, SOFTWARE AND FIRMWARE, IS PROVIDED "AS IS", WITH ALL FAULTS AND ERRORS, AND HIKVISION MAKES NO WARRANTIES, EXPRESS OR IMPLIED, INCLUDING WITHOUT LIMITATION, MERCHANTABILITY, SATISFACTORY QUALITY, FITNESS FOR A PARTICULAR PURPOSE, AND NON-INFRINGEMENT OF THIRD PARTY. IN NO EVENT WILL HIKVISION, ITS DIRECTORS, OFFICERS, EMPLOYEES, OR AGENTS BE LIABLE TO YOU FOR ANY SPECIAL, CONSEQUENTIAL, INCIDENTAL, OR INDIRECT DAMAGES, INCLUDING, AMONG OTHERS, DAMAGES FOR LOSS OF BUSINESS PROFITS, BUSINESS INTERRUPTION, OR LOSS OF DATA OR DOCUMENTATION, IN CONNECTION WITH THE USE OF THIS PRODUCT, EVEN IF HIKVISION HAS BEEN ADVISED OF THE POSSIBILITY OF SUCH DAMAGES.

REGARDING TO THE PRODUCT WITH INTERNET ACCESS, THE USE OF PRODUCT SHALL BE WHOLLY AT YOUR OWN RISKS. HIKVISION SHALL NOT TAKE ANY RESPONSIBILITIES FOR ABNORMAL OPERATION, PRIVACY LEAKAGE OR OTHER DAMAGES RESULTING FROM CYBER ATTACK, HACKER ATTACK, VIRUS INSPECTION, OR OTHER INTERNET SECURITY RISKS; HOWEVER, HIKVISION WILL PROVIDE TIMELY TECHNICAL SUPPORT IF REQUIRED. SURVEILLANCE LAWS VARY BY JURISDICTION. PLEASE CHECK ALL RELEVANT LAWS IN YOUR JURISDICTION BEFORE USING THIS PRODUCT IN ORDER TO ENSURE THAT YOUR USE CONFORMS THE APPLICABLE LAW. HIKVISION SHALL NOT BE LIABLE IN THE EVENT THAT THIS PRODUCT IS USED WITH ILLEGITIMATE PURPOSES.

IN THE EVENT OF ANY CONFLICTS BETWEEN THIS MANUAL AND THE APPLICABLE LAW, THE LATER PREVAILS.

CE This product and - if applicable - the supplied accessories too are marked with "CE" and comply therefore with the applicable harmonized European standards listed under the RE Directive 2014/53/EU, the EMC Directive 2014/30/EU, the LVD Directive 2014/35/EU, the RoHS Directive 2011/65/EU.

WEEE 2012/19/EU (WEEE directive): Products marked with this symbol cannot be disposed of as unsorted municipal waste in the European Union. For proper recycling, return this product to your local supplier upon the purchase of equivalent new equipment, or dispose of it at designated collection points. For more information see: www.recyclethis.info

Battery 2006/66/EC (battery directive): This product contains a battery that cannot be disposed of as unsorted municipal waste in the European Union. See the product documentation for specific battery information. The battery is marked with this symbol, which may include lettering to indicate cadmium (Cd), lead (Pb), or mercury (Hg). For proper recycling, return the battery to your supplier or to a designated collection point. For more information see: www.recyclethis.info



FCC Information

Please take attention that changes or modification not expressly approved by the party responsible for compliance could void the user's authority to operate the equipment.

FCC compliance: This equipment has been tested and found to comply with the limits for a Class B digital device, pursuant to part 15 of the FCC Rules. These limits are designed to provide reasonable protection against harmful interference in a residential installation. This equipment generates, uses and can radiate radio frequency energy and, if not installed and used in accordance with the instructions, may cause harmful interference to radio communications. However, there is no guarantee that interference will not occur in a particular installation. If this equipment does cause harmful interference to radio or television reception, which can be determined by turning the equipment off and on, the user is encouraged to try to correct the interference by one or more of the following measures:

—Reorient or relocate the receiving antenna.

—Increase the separation between the equipment and receiver.

—Connect the equipment into an outlet on a circuit different from that to which the receiver is connected.

—Consult the dealer or an experienced radio/TV technician for help.

This equipment should be installed and operated with a minimum distance 20cm between the radiator and your body.

FCC Conditions

This device complies with part 15 of the FCC Rules. Operation is subject to the following two conditions:

1. This device may not cause harmful interference.

2. This device must accept any interference received, including interference that may cause undesired operation.

Diagram Reference

1 Appearance

- ① Indicator
- ② Front Panel
- ③ Mounting Bracket
- ④ TAMPER Sheet
- ⑤ Rear Panel
- ⑥ TAMPER Button

TAMPER Button

Tampering Alarm: If the tag reader is disassembled, an alarm will be triggered.

Indicator

Armed: Green LED flashes once.

Disarmed: Red LED flashes once.

Formatted: Red LED flashes 3 times.

Enrolled: Green LED flashes 8 times.

Operation Failed: Orange LED flashes once.

Low Battery: Green LED flashes 5 times.

Display Signal Strength:

Under the signal strength checking mode:

Strong Signal: Solid green for 3s (interval: 15s), until the control panel exits the signal strength checking mode.

Weak Signal: Solid red for 3s (interval: 15s), until the control panel exits the signal strength checking mode.

No signal: No light.

2 Power On

1. Loosen the four screws on the rear panel.

2. Remove the rear panel.

3. Install four AAA batteries according to the polarity mark.

Note: 1. Do not reverse the polarity of the battery. 2. Indicators light after powering on. Low power: Green LED flashes 5 times. Normal power: Solid green for 5s.

3. Alkaline batteries are recommended.

3 Enrollment

a) Enroll the Tag Reader Locally

Power on the security control panel. Press the function button once and then present the tag or trigger tampering alarm. Add the tag reader according to the voice prompt. The green LED of the reader will flash 8 times after being successfully enrolled.

Note: The distance between the security control panel and the reader should be less than 50 cm.

b) Register the Tag Reader via APP

1. Log in to the APP Store and input "Hik-Connect" to search the mobile client.

2. Download and install Hik-Connect to your phone.

3. After installing, tap to run the client.

4. Power on the security control panel.

5. Log in the Hik-Connect and tap the icon "H" at the upper-right corner of the Hik-Connect page to add the security control panel. You can scan the QR code on the device rear panel or on the package box, or input the device serial No. manually to add the device when the device is in the registration mode.

6. After adding the security control panel, tap the arming status icon on the right of the security control panel's name to enter the Partition page.

7. Tap the "+" icon on the Partition page to add the peripherals.

8. Register the Tag via Web Client

Enter control panel address in web page to enter the web client. Click "User Management - Card - Add" and swipe the tag on the device. After a beep, the tag information will appear in the list.

4 Installation

1. Check Signal Strength

Press the function button twice on the control panel and then present the tag or trigger tampering alarm to enter the check signal strength mode.

Strong Signal: Solid green for 3s (interval: 15s)

Weak Signal: Solid red for 3s (interval: 15s)

2. Loosen the set screw at the bottom of the reader and remove the mounting bracket.

3. Fix the mounting bracket on the wall with three supplied screws.

4. Hang the tag reader onto the mounting bracket and tighten the set screw.

Note: Installation: open area, far away from metal. Wall: smooth surface, 4 times the weight of the device. Screws: use screws in the accessory bag.

5 Operation

① Away Arming ② Stay Arming ③ Disarming

Formatting

Remove the battery. Hold the TAMPER button and power the reader on at the same time. After 5s, the red LED flashes 3 times, which means the formatting is completed.

Specification

Model	Wireless Tag Reader	
Wireless module	RF speed	10.8kpbs/4.8kpbs
	RF method	Two way communication
	RF encryption	AES-128
	RF frequency	433/868 MHz
	RF modulation	2FSK
	RF distance	800 m (open area)
	RF power	10 dBm
	RF power	1
	TAMPER switch	1
	Indicator	3 colors: red, green and orange
Interface & component	Buzzer	Prompt for tag operation and tampering alarm
	Power	3V DC power input
Electrical & battery	Battery type	4 AAA Batteries
	Battery life span	5 years in stand-by status
	Operation humidity	10% to 90% (no condensing)
	Operation temperature	-20°C to +60°C (-4°F to +140°F)
	Dimension (W × H × D)	90.78 mm × 90.78 mm × 15.5 mm (3.57" × 3.57" × 0.61")
Others	Color	Black and white
	Protection level	IP65
	Installation	Wall mounting

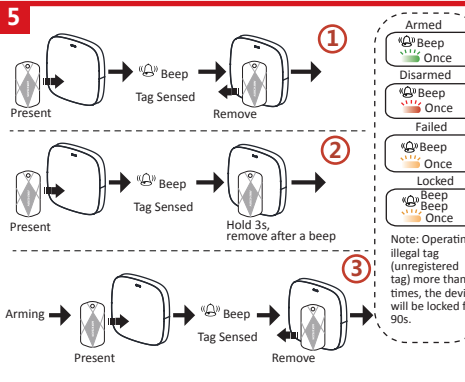
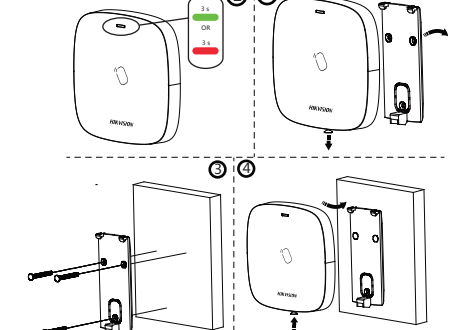
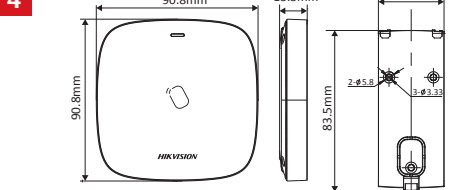
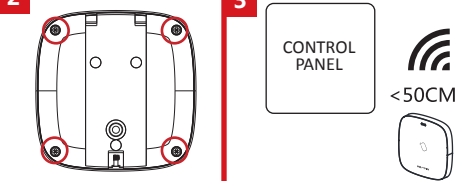
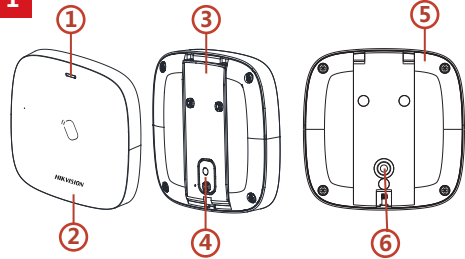

Italiano

Riferimenti agli schemi

Español

Diagrama de referencia

Русский

Пояснения к схемам

Deutsch

Schaubild

Polski

Opis diagramu